



Compression Load Cell CM (CM-Ex) 150

NEW hygienic (aseptic) compression load cell types CM and CM-Ex with 150mm diameter in EHEDG compliant design. These robust digital compression load cells are available in capacities up to 50 tons and produced in electropolished stainless steel and hermetically sealed to IP68 for hygienic weighing installations, installations in tough environments and general process weighing. The load cells can be supplied with a hygienic base plate in AISI316. The compression load cell type CM-Ex can be used in ATEX (Ex) and IECEx applications (Zone 1, 2, 21 and 22)

Type:	CM 150 (Non-ATEX) CM-EX 150 (ATEX)
Capacity (Emax):	25000, 30000, 40000, 50000kg
Accuracy:	Industrial 0.10%
Overload Tolerance:	Up to 300% of rated capacity

- EHEDG compliant hygienic (aseptic) design without gaps or edges for easy cleaning to minimize the risk of bacteria growth
 - Developed and manufactured in Denmark
 - Low profile and hygienic design
 - High tolerance of up to 1000% overload
 - Robust capacitive technology
 - Hermetically sealed to IP68
 - Electropolished stainless steel 1.4542 (17-4 PH)
 - Laser welded with Duplex 1.4462 stainless steel
 - ATEX and IECEx certified (Zone 1, 2, 21, 22)
 - Easy mechanical and electrical installation
-
- High accuracy, High resolution
 - Capacity (Emax): 25000, 30000, 40000, 50000 kg
 - Accuracy: Industrial 0.10%

- Load cell cable length up to 100meters
- Load cell calibration independent of cable length
- Load cell cable replaceable on-site
- Withstands welding voltages and ESD
- Can be used in both ATEX / IECEx and non-ATEX installations

- **CM (CM-Ex) Datasheet**

- **Dimensions digital Compression Load Cell Type CM CM-Ex Ø150 max. 50ton PDF**
- **Digital Compression Load Cell Type CM CM Ø150 max. 50ton STEP 3D CAD File (Right click - Save Link As)**
- **Hygienic Base Plate for CM CM-Ex Ø150 max. 50ton M16 dimensions PDF**
- **Hygienic Base Plate for CM CM-Ex Ø150 max. 50ton M16 STEP 3D CAD File (Right click - Save Link As)**
- **Standard Base Plate for CM CM-Ex Ø150 max. 50ton dimensions PDF**

- **ATEX Certificate SEV23 ATEX 0689 X (ENG) PDF**
- **IECEx Certificate SEV 23.0028 X (ENG) PDF**
- **Guideline Correct Mounting of BNC Connector (UK) PDF**
- **VIDEO - Correct Mounting of BNC Connector (UK)**

CM (CM-Ex)
Capacity 25 to 50 ton

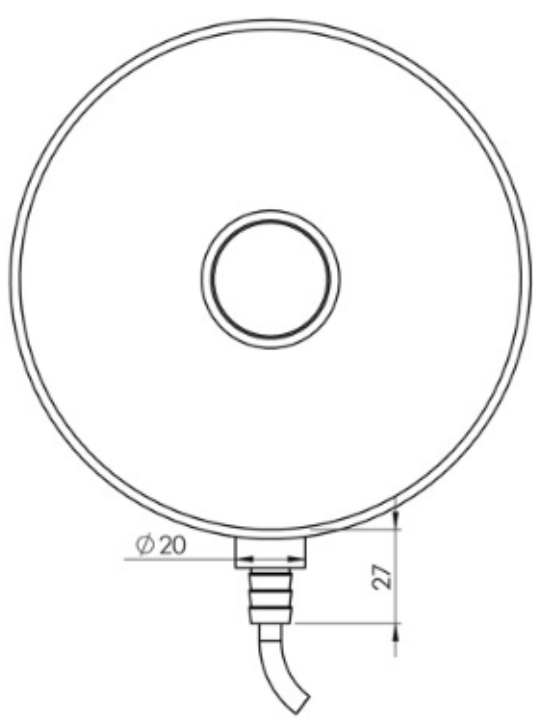
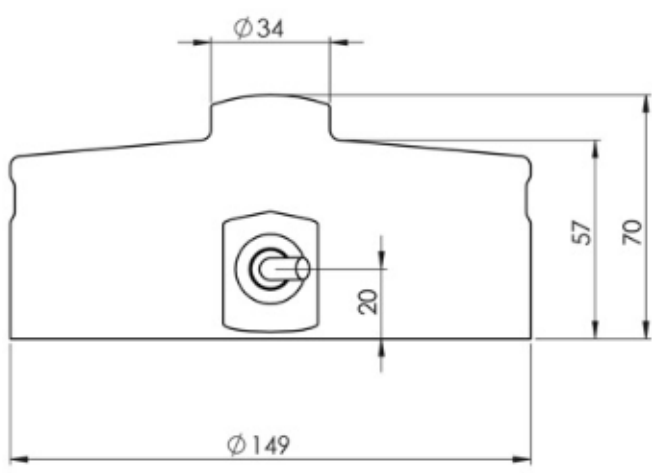
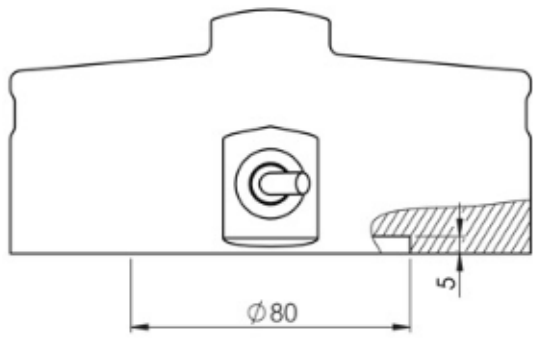

Parameter	Unit	0.10%
Rated capacity (E_{max})	kg	25000, 30000, 40000, 50000
Safe overload limit	% of E_{max}	up to 300
Safe sideload limit	% of E_{max}	up to 300
Minimum dead load	% of E_{max}	0
Accuracy	% of E_{max}	0.100
Repeatability	% of E_{max}	0.030
Hysteresis	% of E_{max}	0.055
Creep 30 min.	% of E_{max}	0.060
Temperature effect on zero	% /10°C	0.060
Temperature effect on sensitivity	% /10°C	0.060
Compensated temperature range	°C	-10 to 50
Operating temperature range	°C	-50 to 70
Deflection at E_{max}	mm	max 0.10
Measuring rate	Hz	500
Supply	Vdc	24Vdc ±5%
Internal resolution	Bit	24
Material		Stainless Steel 17-4 PH and AISI 316
Protection		IP68
Cable		6meter standard coaxial RG-58 (Ø6mm) with BNC connector
Maximum load cell cable length	m	100
Weight	kg	6.5
Output options		EtherNet/IP, PROFINET, EtherCAT, Modbus TCP/IP, Profibus DP, DeviceNet, RS485, 4-20mA, 0-10Vdc

- Tank weighing
- Process weighing
- Level measurement
- Filling and dosing
- Large Vessels
- Offshore applications
- Heavy duty applications

- ATEX and IECEx (Zone 1, 2, 21, 22) version type CM-Ex
- ATEX II 2G Ex ia IIC T6 Gb / ATEX II 2D Ex IIIC T85°C Db
- Hygienic and Standard Base Plate available
- Load cell cable length 10, 20, 50 or 100meters
- Mud resistant and Halogen free cables for offshore installation
- Special PE load cell cable available for freezing low temperature (can be used down to -50 degrees Celsius)
- Special Teflon load cell cable available for very high temperature (can be used up to 100 degrees Celsius)