

## Beam Load Cell SDM70

Robust digital heavy duty beam load cell produced in stainless steel and hermetically sealed to IP68 for process weighing, industrial weighing and tough applications such as on-board truck weighing, offshore, steel industry etc. OIML certified (up to C5) according to R60

|                            |  |
|----------------------------|--|
| <b>Type:</b>               | SDM70  |
| <b>Capacity (Emax):</b>    | 1000, 2000, 3000kg                                     |
| <b>Accuracy:</b>           | 0.10% C1, 0.05% C2, 0.025% C3 og op til OIML klasse C5 |
| <b>Overload Tolerance:</b> | Up to 500% of rated capacity                           |

- Made in Denmark
- Stainless steel 1.4542 (17-4 PH)
- Robust capacitive technology
- Patented high reliability capacitive sensor
- OIML R60 accuracy classes up to C5
- High tolerance of up to 1.000% overload
- Hermetically sealed to IP68
- Laser welded with Duplex 1.4462 stainless steel

- High accuracy, High resolution
- Digital filters
- Capacity (Emax): 1000, 2000, 3000kg
- Accuracy: Industrial 0.10% up to OIML class C5
- Cable length up to 100meters
- Calibration independent of cable length
- Load cell cable replaceable
- Easy mechanical and electrical installation
- Withstands welding voltages and ESD

- [R60-2002.1 SDM OIML test certificate PDF](#)
- [Digital Beam Load Cell SDM70 Dimensions PDF](#)
- [SDM70 3D Digital Beam Load Cell PDF](#)
- [SDM70 Beam Load Cell STEP 3D CAD File \(right click -> "Save Link As..."\)](#)
- [Guideline Correct Mounting of BNC Connector \(UK\) PDF](#)
- [VIDEO - Correct Mounting of BNC Connector](#)

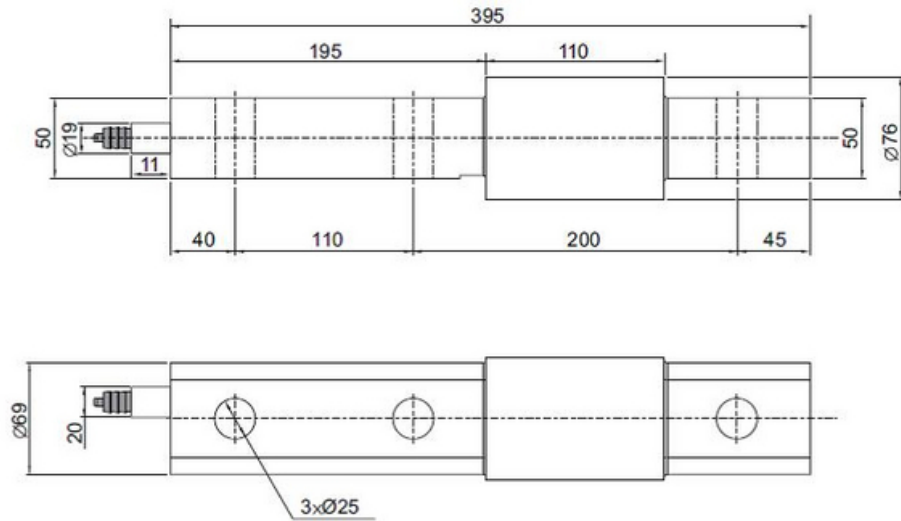

| Parameter                         | Unit           | 0.10% | 0.05%  | 0.025% C3 |
|-----------------------------------|----------------|-------|--|-----------|
| Rated capacity ( $E_{max}$ )      | kg             |       | 1000, 2000, 3000   |           |
| Safe overload limit               | % of $E_{max}$ |       | 300 to 500   |           |
| Safe sideload limit               | % of $E_{max}$ |       | 500 to 1000  |           |
| Minimum dead load                 | % of $E_{max}$ |       | 0  |           |
| Combined accuracy                 | % of $E_{max}$ | 0.100 | 0.050  | 0.025     |
| Repeatability                     | % of $E_{max}$ | 0.030 | 0.025  | 0.015     |
| Hysteresis                        | % of $E_{max}$ | 0.050 | 0.030  | 0.018     |
| Creep 30 min.                     | % of $E_{max}$ | 0.040 | 0.030  | 0.020     |
| Temperature effect on zero        | % / 10°C       | 0.060 | 0.055  | 0.040     |
| Temperature effect on sensitivity | % / 10°C       | 0.060 | 0.055  | 0.040     |
| Compensated temperature range     | °C             |       | -10 to 50  |           |
| Operating temperature range       | °C             |       | -50 to 70 (100*)   |           |
| Deflection at $E_{max}$           | mm             |       | 0.10   |           |
| Measuring rate                    | Hz             |       | 500  |           |
| Supply                            | Vdc            |       | 24Vdc ±5%  |           |
| Internal resolution               | Bit            |       | 24   |           |
| Material                          |                |       | Stainless Steel 17-4 PH and AISI 316   |           |
| Protection                        |                |       | IP68   |           |
| Cable                             |                |       | 6meter standard coaxial RG-58 (Ø6mm) with BNC connector  |           |
| Maximum cable length              | m              |       | 100  |           |
| Weight                            | kg             |       | 9.5  |           |
| Output options                    |                |       | EtherNet/IP, PROFINET, EtherCAT, Profibus DP, Modbus TCP/IP, DeviceNet, RS485, 4-20mA, 0-10Vdc |           |

\* with Teflon cable

- Dynamic weighing
  - Process weighing
  - Mobile weighing
  - Vibration feeders
  - Big-bag equipment
  - Hopper scales
  - Conveyor scales
  - Heavy duty platform scales
  - Heavy duty applications
  - Offshore application
- 
- Mounting kits available
  - Customized versions available
  - Load cell cable length 10, 20, 50 or 100meters
  - Special PE load cell cable available for freezing low temperature (can be used down to -50 degrees Celsius)
  - Special Teflon load cell cable available for very high temperature (can be used up to 100 degrees Celsius)